

STING

Electromechanical automation for swing gates
up to 3m - 400 kg



For residential and
collective usage



Available in 230V and 24V



#fastasyoulike!
STING/BOOST
gate opening at 90° in 9"



STING

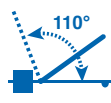

Door opening up to 110°.

Robust and reliable operator, in an enclosed body



Quick unlocking with customised metal key



Get rid of ground stops by using the mechanical stops (optional)

Reversible version
art. STING/24/R



No risk of the gate operation stopping in a power outage thanks to the backup batteries (optional, art. BAT, code 629290) that can be installed on 24V models



The DE@NET external universal control board makes this operator compatible with NETLINK System.



NETCOM

Compatible with NETCOM, the device for installation, maintenance and remote management, from your office!



Greater installation versatility thanks to the adjustable fixing plates excluded (art. MLS/SFR)



STING	Opening time about 90 °	16"
STING/BOOST		9"
STING/24/R		12"

Note: the opening time may increase depending on the characteristics of the installation

Fast maneuvering with STING/BOOST: the 24V model of the STING range with a minimum opening time of 90° in 9 seconds. Available in kit.



Models

230V ~ operators without control board



COD.	Art.		STROKE	ENCODER	OTHER CHARACTERISTICS
625050	STING	●	395mm without MAC/FM 334mm with MAC/FM		• For leaves up to 3m length
625052	STING/EN	●	395mm without MAC/FM 334mm with MAC/FM	✓	• With encoder, for leaves up to 3m
625058	STING/EN-BLACK	●	395mm without MAC/FM 334mm with MAC/FM	✓	• For leaves up to 3m length

All models have: adjustable fixing plates to be screwed included (art. MLS/SFR)

Control board to complete the installation: control board cod. 677610 art. NET230N/C (with box)

24V ~ operators without control board





COD.	Art.		STROKE	OTHER CHARACTERISTICS
625051	STING/24	●●	395mm without MAC/FM 334mm with MAC/FM	• For leaves up to 3m length
625059	STING/24-BLACK	●●	395mm without MAC/FM 334mm with MAC/FM	• For leaves up to 3m length
625056	STING/24-BOOST (37 mm/s)	●●	395mm without MAC/FM 334mm with MAC/FM	• For leaves up to 3m length
625060	STING/24/R *	●●●	395mm without MAC/FM 334mm with MAC/FM	• For leaves up to 3,5m length / 300kg • Reversible

All models have: adjustable fixing plates to be screwed included (art. MLS/SFR)

Control board to complete the installation: control board cod. 678261 art. NET24N/C (with box)

* **Supplied with:** adjustable brackets, 1pc Omron socket and 1pc monostable relay

TECHNICAL INFO	STING	STING/EN	STING/24	STING/24-BOOST	STING/24/R
Motor power supply (V)	230V ~ ± 10 % (50/60 Hz)		24V 		24V 
Maximum power absorption (W)	300		60	85	60
Max thrust (N)	1650		1000	1000	1000
90° Opening time (s)*	16			9	11,6
Duty cycle (cycles/hours)	18	22	40		
N. max cycles in 24h.	90				-
Built-in capacitor (µF)	8		/		/
Operating temperature (°C)	(-20°) - (50°)				
Motor thermal protection (°C)	150		/		/
Weight with packing (Kg)	8,8				
Sound pressure (dBA)	< 70				
Protection rating	IPX4				

*the opening time of the leaf at 90° may be different according to the characteristics of the installation

Scan the QR CODE to view all the content we have created on this operator



STING



STING/24/R



Example of a typical installation

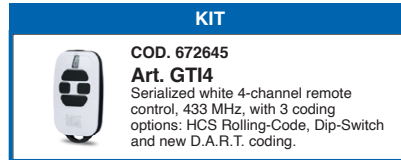
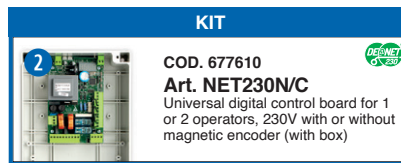
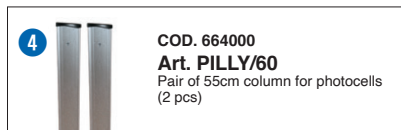

KIT for further details on the kits see price list

Specific accessories

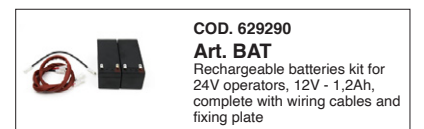
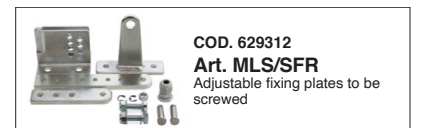

Guide to use

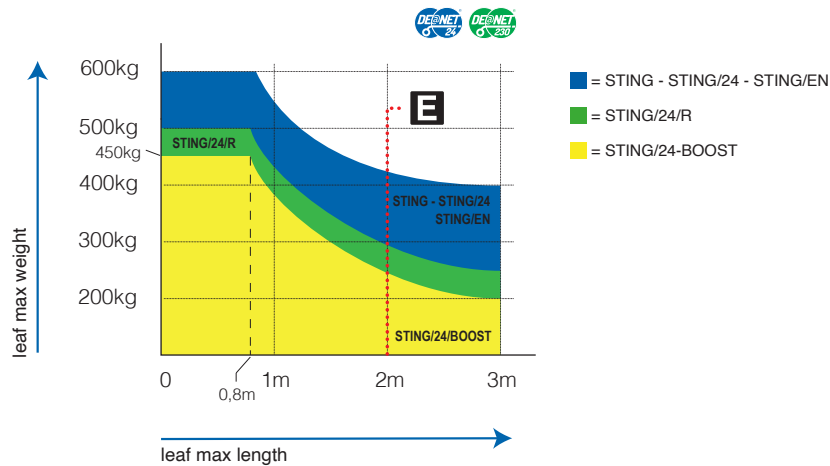

If the leaf length is bigger than 2m or if you use reversible models you must install the electric-lock to block the gate in closed position. The height and the leaf structure, as well as the presence of strong wind, can cause the reduction of the value of the data contained in table or make it necessary to use an electric lock also for leafs shorter than 2m.

Wiring

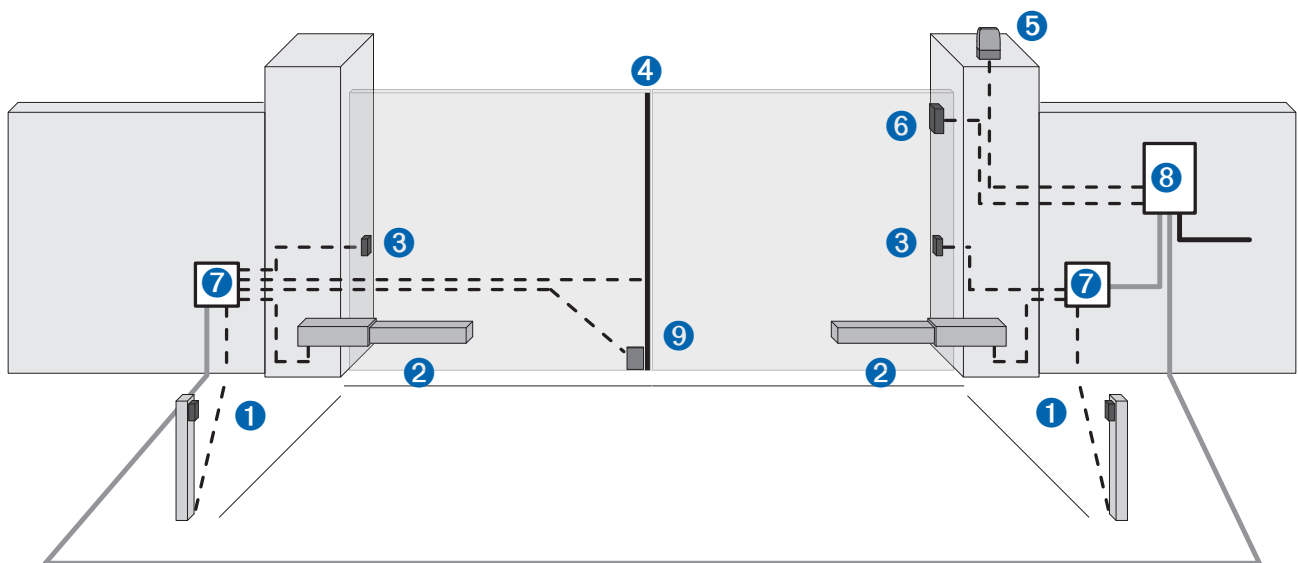

- Corrugated pipe for power supply cable
- Ø40 corrugated pipe for connection between the control board and the junction box
- - - Ø20 corrugated pipe or external PVC conduit for connection between the control board and the command and safety accessories

pos.	description
1	Column with photocells
2	Operator
3	Photocells
4	Safety edge
5	Flashing light
6	Key switch/Keypad
7	Junction box
8	Control board
9	Electric-lock

Dimensions

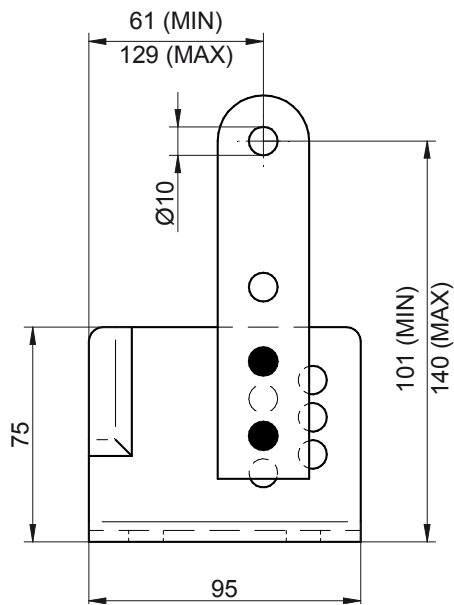
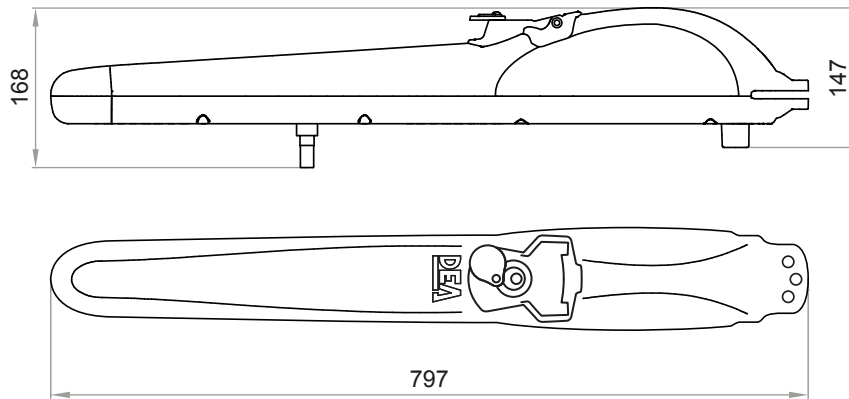

rear

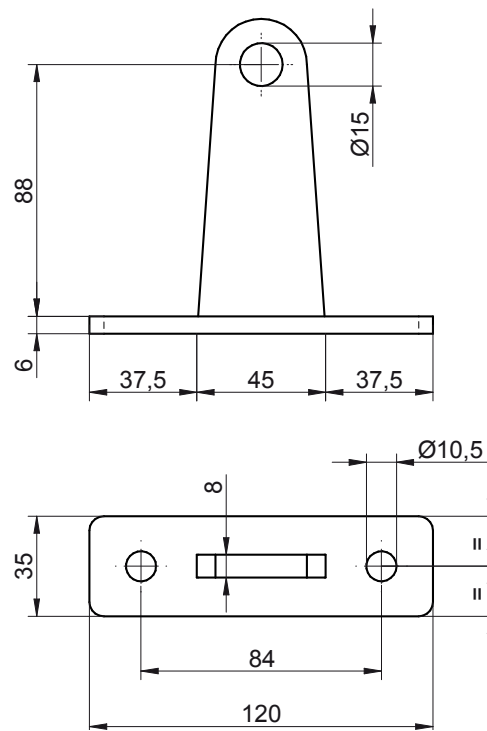

front

Installation dimensions

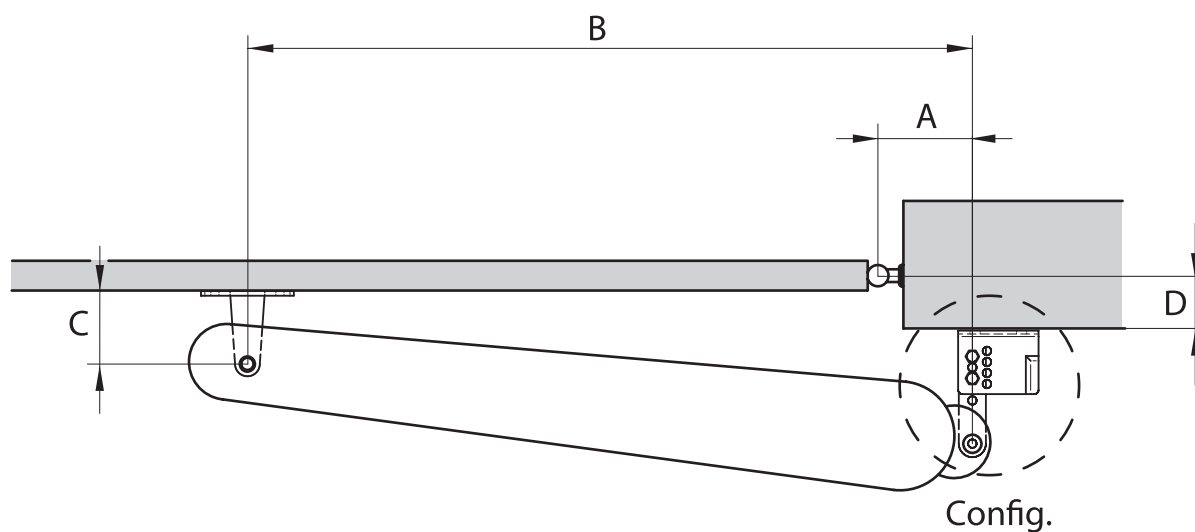

Art. STING	
Config. 1	Config. 2

STING + Art. MAC_FM						
	Config.	A	B	C	D	Note
90°	1	125	685	94	0÷50	* Senza fermi meccanici in apertura (corsa max 367 mm), Without mechanical stops in opening (max stroke 367 mm), Sans arrêts mécaniques en ouverture (course maxi 367 mm), Ohne mechanische Anschläge an Öffnung (max Hub 367 mm), Sin finales de carrera mecánicos en abertura (recorrido max 367 mm), Sem fins de cursos mecânicos no abertura (curso Max. 367mm), Bez ograniczników mechanicznych na otwarcie (max wysuw 367 mm), Без механических упоров на открытие (ход штока макс 367 мм).
	2	125	685	94	50÷75	
	2	140	685	109	75÷100*	
	2	140	685	114	100÷125*	
100°	1	160	690	104	0÷25*	

STING						
	Config.	A	B	C	D	Note
90°	1	125	720	94	0÷50	
	2	125	715	94	50÷100	
	2	150	715	124	100÷125	
100°	1	160	720	104	0÷25	
	1	170	720	109	25÷50	
110°	1	185	720	99	0	
	2	185	720	99	25	

DEAuser



DEAuser is the app for **private users** that allows activation of automation at **close proximity** via Bluetooth.

By installing NET-NODE on all devices with NETLINK technology, you can control your gate through your smartphone.

To be used with:



Art.NET-NODE 2.0
Cod.677642



DEAinstaller



DEAinstaller is the App dedicated to the **professional installer** and allows Installers to program and manage DEA automations on-site in a simple and intuitive way from their smart devices.

If you use it with the NET-NODE you can:

- ✓ keep a **data backup** of all your installations
- ✓ easily adjust the **parameters** of your control boards
- ✓ update the **firmware**
- ✓ program the **maintenance**
- ✓ manage or customise the **remotes**
- ✓ read **technical manuals** or have a look at the **electrical connections**
- ✓ control the **inputs** and **output** of the control boards
- ✓ **control** the automation with the App

To be used with:



Art.NET-NODE 2.0
Cod.677642

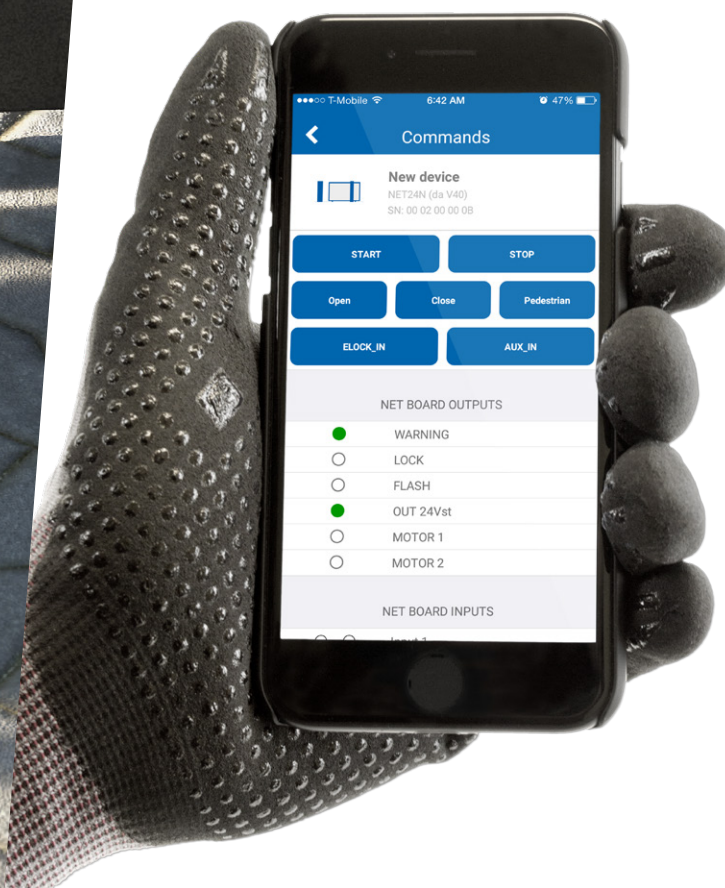

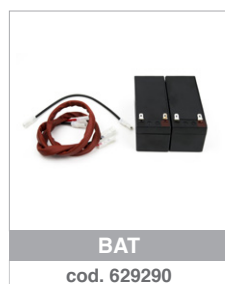
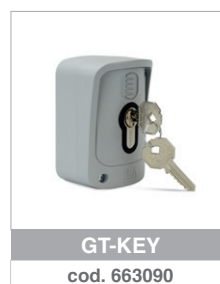

#safeasyoulike!

Non-copyable remotes!

GTI remotes are multi-function. They have three coding possibilities: DIP SWITCH, Rolling Code and D.A.R.T. the new DEA advanced coding.

You can customise the code of the remotes to guarantee the maximum security to your customer.

D. DEA

A. Advanced

R. Rolling Code

T. Transmission

Looking for **total safety**? With **NET-BOX** each installer can customise the code of your GTI remotes.



#colourasyoulike!

Choose your favorite colour!

GTI remotes can be customised with button kits in seven colours: green, light green, blue, pink, yellow, orange and purple.



Note: button kits are supplied in packs of 5. The remote must be ordered separately.



NETLINK

is our technology applied to DEA devices for the smart management of your installations, both **locally** and **remotely**.

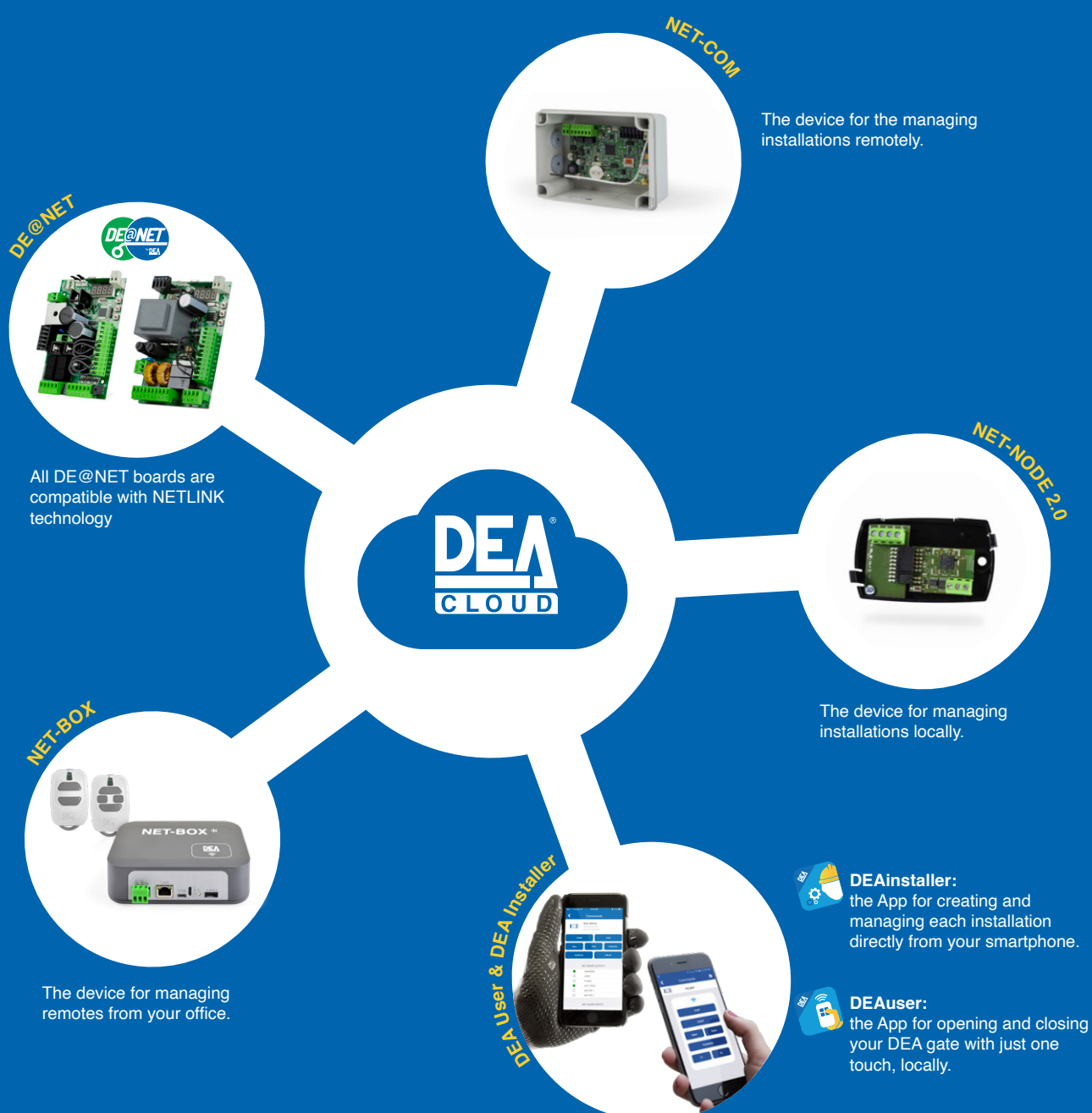

Our range

Automations for sliding gates



LIVI/N



REV



NEW



GULLIVER/N



Automations for sectional doors



SPACE/N



ADVANCE/N



LIVI 902



Automations for swing gates



MAC



STING



LOOK



GEKO



LIVI 502



GHOST 100/200



OLI/N



Automations for industrial gates



LATO



550 PL



Barriers



PASS/N



STOP/N



NEW



TRAFIK/N



Bollards

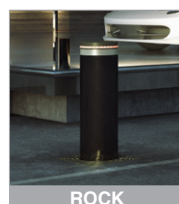

ROCK



HEADQUARTER
DEA SYSTEM S.p.A.
 Via della Tecnica, 6 - 36013 Piovene Rocchette (VI) - ITALY
 ☎ + 39.0445.55.07.89 - 📠 + 39.0445.55.02.65
 info@deasystem.com - www.deasystem.com

Branches > Italy, France, United Kingdom, Ireland, España, Portugal, Polska, Deutschland, Беларусь

> HEAD OFFICE

DEA System UK & IRE

Sandholes Road - Cookstown - Co. Tyrone

BT80 9AR - IRELAND

☎ + 44 (0)28 8676 6476 - 📠 + 44 (0)28 8676 2414

info@deasystem.net

DEA System UK & IRE

Unit 29-31 - The IO Centre - Hearle Way - Hatfield -

Hertfordshire AL10 9EW - UNITED KINGDOM

☎ + 44 (0)1707 246 599

contact@deasystem.net